



DINO PAOLI SRL

Price List

paoli 正規取扱店



〒221-0014
神奈川県横浜市神奈川区入江1-28-9
(もりふじビル)

株式会社 モーラ

TEL:045-402-6600 FAX:045-402-6601

Motorsport 2011_Price List <Release: CGM110101.01>

DINO PAOLI SRL

Wheel Guns

※下記価格には国内送料、輸入運賃、関税、手数料が含まれます。

※消費税は別途申し受けます。

Wheel Gun	Model	Old Code	New Code	標準価格 (税抜き)
DP4000	RH-RED/SILVER	A4000RH	004000.00002	¥ 687,500
	LH-BLUE/SILVER	A4000LH	004000.00001	
	UH-BLACK/SILVER	A4000UH	004000.00003	
DP3000	RH-GOLD	A3000RH	003000.00001	¥ 611,900
	LH-SILVER	A3000LH	003000.00002	
	UH-BLACK	A3000UH	003000.00014	
DP2000-S	RH-YELLOW	A2000SRH	020005.00003	¥ 431,400
	LH-BLACK	A2000SLH	020005.00002	
	UH-SILVER	A2000SUH	020005.00001	
DP197-SF	RH-RED	A197SFRH	0197SF.00003	¥ 323,200
	LH-BLUE	A197SFLH	0197SF.00002	
	UH-SILVER	A197SFUH	0197SF.00001	
DP176-SF 3/4"	RH-RED	A176SFRH	0176SF.00004	¥ 214,900
	LH-BLUE	A176SFLH	0176SF.00003	
DP34-SF 3/4"	RH-RED	A34SFRH34	0034SF.00002	¥ 119,200
	LH-BLUE	A34SFLH34	0034SF.00001	
DP36-SF 1/2"	RH-RED	A36SFRH	36SFMS.0000.	¥ 75,900
	LH-BLUE	A36SFLH	36SFMS.00001	

Accessori_Accessories

※国内送料が別途、実費ご請求に成ります。(輸入運賃、関税、手数料は含まれています。)

※消費税は別途申し受けます。

Old Code	New Code	Description	標準価格 (税抜き)
<u>Air pressure regulators</u>			
RGPRSF1	D.03.06.0003	Air pressure regulator for Wheel Guns application	¥76,900
RGPRSF6	D.03.06.0012	Mini Air pressure regulator for Wheel Guns application	¥48,500
RGPRSF2	D.03.06.0002	Air pressure regulator for Air Jack application	¥85,400
RGPRSF7	D.03.06.0013	Mini Air pressure regulator for Air Jack application	¥53,300
RGPRSF4	D.03.06.0005	Balanced air pressure regulator for Wheel Guns application	¥86,300
***	D.03.03.0005	Fixing Ring Nut for Air Pressure Regulator	¥4,800
COD-FR-J	B.01.0003	French-Japanese bottle connector	¥7,200
COD-D	B.01.0002	German bottle connector	¥13,400
COD-IT	B.01.0005	Italian bottle connector	¥7,200
COD-US	B.01.0007	American bottle connector	¥9,800
COD-N2	B.01.0006	Nitrogen bottle connector	¥7,200
COD-BSP	B.01.0001	British Standard Parallel bottle connector	¥13,000
COD-FR-N2	B.01.0004	French-Nitrogen bottle connector	¥10,400
BCS	D.03.08.0001	Bottle connection support	¥8,500
RCA101RACY	D.09.17.0068	Y Joint with male-female-female thread	¥2,500
OPV	D.03.07.0022	Overpressure valve	¥10,300
MAN60	D.03.02.0006	0-60 bar gauge - out	¥5,700
MAN100	D.03.02.0008	0-100 bar gauge - out	¥5,700
MAN300	D.03.02.0007	0-315 bar gauge - in	¥5,700
COVERMAN	D.03.02.0004	Gauge protective cover - blue	¥1,300
MAN100SPEC	D.03.02.0010	0-100 bar gauge - out w/glycerine bath	¥8,500
MAN300SPEC	D.03.02.0011	0-300 bar gauge - in w/glycerine bath	¥8,500
COVERMASPEC	D.03.02.0012	Gauge protective cover - black	¥1,500
***	B.21.0034	50 cm long, DIN 200 bar high pressure hose _connection bottle-regulator	¥37,400
<u>Air bottle compressors</u>			
DPH13/SM		Electric Three Phase Compressor	¥1,290,900
DPH6/SH	B.21.0001	Petrol Engine Compressor	¥517,300
DPH6/SM	B.21.0002	Electric Single Phase Compressor	¥495,700
	B.21.0075	Kit - Autodrain with timer	¥97,000
	B.21.0074	Kit - Autostop	¥97,000
	B.21.0069	Case for Paoli Compressor	¥148,800

Old Code	New Code	Description	標準価格 (税抜き)
<u>Compressors Standard Fitting</u>			
	B.21.0024	Compressor Standard Fitting – DIN 300	¥32,400
	B.21.0007	Compressor Optional Fitting – DIN 230	¥32,400
	B.21.0066	Compressor Optional Fitting – INT/YOKE	¥38,900
	B.21.0044	Compressor Optional Fitting – ITALIAN CONNECTOR	¥32,400
	B.21.0014	Compressor Optional Fitting – BC DIN 230	¥38,900
	B.21.0064	Compressor Optional Fitting – BC DIN 300 USA	¥43,200
	B.21.0025	Compressor Optional Fitting – BC DIN 300	¥43,200
	B.21.0028	Compressor Optional Fitting – BC ITALIAN CONNECTOR	¥43,200
	B.21.0065	Compressor Optional Fitting – BC INT	¥43,200
	B.21.0067	Compressor Optional Fitting – DIN/INT REDUCER	¥38,900
<u>PitRunner</u>			
	C.01.0006	pitRunner	¥668,200
	C.01.0007	pitRunner Docking Station	¥64,800
<u>Air bottles</u>			
TK700130/M	B.22.01.0000	15 litres Air Bottle w/single valve	¥83,300
TK700130	B.22.01.0003	15 litres Air Bottle w/double valve	¥96,200
TK700140/M	B.22.01.0002	18 litres Air Bottle w/single valve	¥109,400
TK700140	B.22.01.0001	18 litres Air Bottle w/double valve	¥122,300
SCTKRMO	B.22.04.0000	Single valve for bottle	¥12,200
SCTKRBI	B.22.04.0001	Double valve for bottle	¥21,700
SCTKRUN	B.22.04.0003	Universal (single/double) valve for bottle	¥43,200
SCTKRUNTA	B.22.04.0004	Screw plug for universal valve	¥5,500
<u>Air bottle trolley</u>			
AB-TROLLEY	C.01.0003	Air bottle trolley (with kit)	¥89,500
	C.01.0005	Double Air bottle trolley (with belt)	¥105,700
<u>Hoses</u>			
CTG13X24T/75	M.12.01.0004	75 bar hose (per meter)	¥2,500
CTG10X19T/50	M.12.01.0001	50 bar hose (per meter)	¥2,000
WHSC	B.20.01.0000	18" Whip Hose w/Swivel Fitting	¥16,300
WHTC	B.20.01.0001	18" Whip Hose w/360° Turning Connector	¥22,500
RDF38	D.09.17.0018	3/8" straight female hose tting	¥2,200
RDF12	D.09.17.0019	1/2" straight female hose tting	¥2,200
RCF38-45	D.09.17.0023	3/8" angle 45° female hose tting	¥2,200
RCF38-90	D.09.17.0024	3/8" angle 90° female hose tting	¥2,200
RCF12-45	D.09.17.0021	1/2" angle 45° female hose tting	¥2,200
RCF12-90	D.09.17.0022	1/2" angle 90° female hose tting	¥2,200

Old Code	New Code	Description	標準価格 (税抜き)
<u>Hose Reels</u>			
	B.33.0001	50/75 Bar Hose Reel	¥45,200
<u>Turning connectors</u>			
DV11MFG38	D.09.17.0028	3/8" Gas Male/Female 360° Turning – 90° Flexing Hose Connector	¥20,500
RV11MFB38		3/8" Gas Male/Female Swivel Hose Connector	¥13,000
<u>Couplings</u>			
SC38	D.09.17.0055	3/8" Gas w/safety device and locking pressure system Female	¥11,000
PCSC	B.18.0008	Orange plastic cover x SC38	¥400
SC12	D.09.17.0066	1/2" Gas w/safety device and locking pressure system Female	¥11,900
320-1154	D.09.17.0051	3/8" Gas Light Duty Female Quick Disconnect Coupling	¥4,000
320-1155	D.09.17.0049	1/2" Gas Light Duty Female Quick Disconnect Coupling	¥4,200
320-1258	D.09.17.0057	3/8" Gas Light Duty Female Quick Disconnect Coupling for Hose Application	¥5,000
320-5264	D.09.17.0040	3/8" Gas Light Duty Male Quick Disconnect Coupling for Hose Application	¥2,500
320-5154	D.09.17.0043	3/8" Gas Light Duty Male Quick Disconnect Coupling	¥2,000
320-5155	D.09.17.0042	1/2" Gas Light Duty Male Quick Disconnect Coupling	¥2,300
410-1154	D.09.17.0033	3/8" Gas Heavy Duty Female Quick Disconnect Coupling	¥5,000
410-1155	D.09.17.0032	1/2" Gas Heavy Duty Female Quick Disconnect Coupling	¥5,300
410-5154	D.09.17.0037	3/8" Gas Heavy Duty Male Quick Disconnect Coupling	¥2,500
410-5155	D.09.17.0036	1/2" Gas Heavy Duty Male Quick Disconnect Coupling	¥2,800
<u>Spare parts</u>			
	R.02.01.01.0023	Ceramic Bearings upgrade	¥76,200
KIT4000	B.23.0040	Service Kit for DP 4000 RH-LH-UH	¥44,000
KIT3000	B.23.0040	Service Kit for DP 3000 RH-LH-UH	¥44,000
KIT2000S	B.23.0031	Service Kit for DP 2000-S RH-LH-UH	¥31,500
KIT197SF	B.23.0030	Service Kit for DP 197-SF RH-LH-UH	¥29,400
KIT176SF	B.23.0028	Service Kit for DP 176-SF RH-LH	¥25,800
KIT34SF	B.23.0033	Service Kit for DP 34-SF RH-LH	¥25,800
KIT36SF	B.23.0045	Service Kit for DP 36-SF RH-LH	¥25,800

Old Code	New Code	Description	標準価格 (税抜き)
Optionals			
	B.23.0014	3-port Gun Selector Plate Kit	¥192,300
FAD2000	L.19.0001	Fibreglass Air Detector for DP 2000-S	¥16,000
RAD2000	B.17.0001	Rubber Coated Air Detector for DP 2000-S	¥23,500
KAD2000	B.17.0002	Kevlar Air Detector for DP 2000-S	¥31,300
COVERPT5	B.18.0013	2 mm transparent plastic cover for DP 3000	¥11,000
COVERPT	B.18.0000	2 mm transparent plastic cover for DP 2000-S	¥11,000
COVERPT2	B.18.0001	2 mm transparent plastic cover for DP 197-S DP 197-SF	¥11,000
COVERPT3	B.18.0003	2 mm transparent plastic cover for DP 176-SF	¥8,500
COVERPT4	B.18.0006	2 mm transparent plastic cover for DP 34-SF/DP 30-SF /DP 36-SF	¥8,500
COVERB4B2	B.18.0014	4 mm black rubber cover for DP 3000	¥11,000
COVERRB4B	B.18.0005	4 mm black rubber cover with PAOLI logo for DP 2000-S	¥11,000
COVER	B.18.0004	2 mm black rubber cover for DP 34-SF/DP 30-SF /DP 36-SF	¥8,500
COVERPT4	B.18.0006	2 mm transparent plastic cover for DP 34-SF/DP 30-SF /DP 36-SF	¥8,500
FRS	B.31.0001	Fast Reverse System	¥10,300
BAG	B.19.0000	Wheel gun bag	¥21,900
Wheel nut sockets & nuts			
***	B.28.0001	Metalore Titanium Socket for IRL application	¥319,000
BCF430TI	B.28.0002	Metalore Titanium Socket for F.430 application	¥344,900
DMSF430RH	B.32.0002	Metalore RH Wheel Nut for F.430 application	¥119,900
DMSF430LH	B.32.0001	Metalore LH Wheel Nut for F.430 application	¥119,900
***	B.28.0006	Metalore Titanium Socket for Porsche 997-RSR application	¥436,900
***	B.32.0004	Metalore RH Wheel Nut for Porsche 997-RSR application	¥119,900
***	B.32.0003	Metalore LH Wheel Nut for Porsche 997-RSR application	¥119,900
***	***	Metalore Titanium Socket customized on demand	***
***	***	More Wheel Nut Sockets & Wheel Nut customized on demand	***
Socket Retainers			
	D.09.03.0024	Socket retainer for 1" Square Drive	¥900
	D.09.03.0026	Socket retainer for 3/4" Square Drive	¥700
	D.09.03.0025	Socket retainer for 1/2" Square Drive	¥400
Lubricants			
COL1	B.27.0004	Special Oil for PAOLI Air Impact Wrench Motors – 1 litre	¥2,400
COL2	B.27.0011	Special Oil for PAOLI Air Impact Wrench Motors – 2 litres	¥4,300
COL5	B.27.0005	Special Oil for PAOLI Air Impact Wrench Motors – 5 litres	¥7,900
CGRM	B.27.0015	Special Grease for PAOLI Air Impact Wrench Hammer Mechanism – 1Kg	¥7,400
	B.27.0016	Special Spray Lubricant for PAOLI Air Impact Wrench Motors	¥11,900

Accessori_Accessories

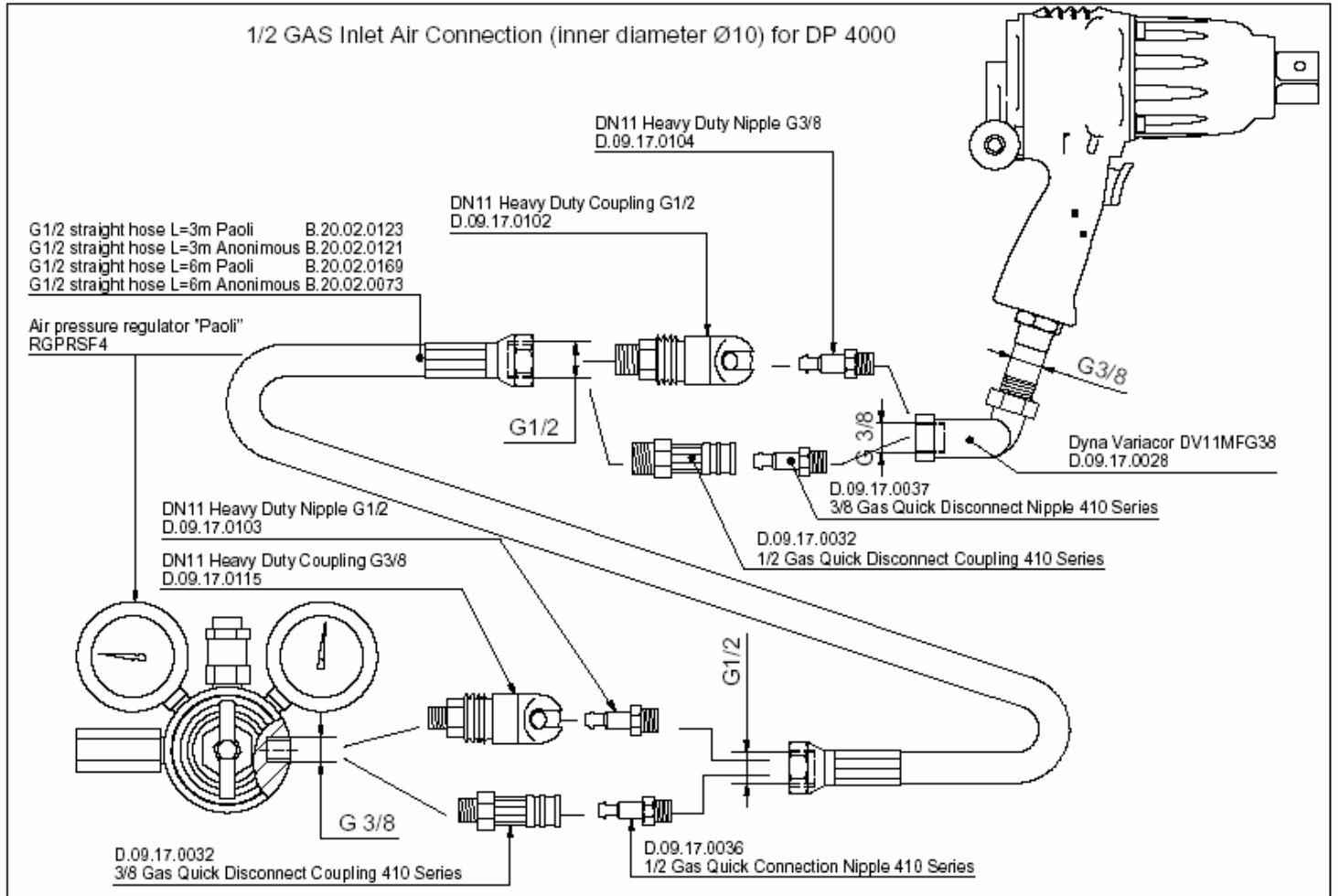

※国内送料が別途、実費ご請求に成ります。(輸入運賃、関税、手数料は含まれています。)

※消費税は別途申し受けます。

Code	Description	標準価格
------	-------------	------

1/2 GAS Inlet Air Connection (inner diameter Ø10) for DP 4000

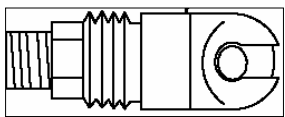

D.09.17.0115	DN11 Heavy Duty Swing Coupling G3/8 (3/8" THREADED SWING COUPLING SERIES H)	¥27,900
--------------	--	---------

D.09.17.0102	DN11 Heavy Duty Swing Coupling G1/2 (1/2" THREADED SWING COUPLING SERIES H)	¥27,900
--------------	--	---------

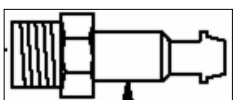

D.09.17.0104	DN11 Heavy Duty Nipple G3/8 (3/8" MALE ADAPTOR SERIES H)	¥6,000
--------------	---	--------

D.09.17.0103	DN11 Heavy Duty Nipple G1/2 (1/2" MALE ADAPTOR SERIES H)	¥6,000
--------------	---	--------

BEST PRACTICE : Left Handed Mechanics



D.01.14.0027	3 PORT WELDED SPOOL	¥35,800
--------------	---------------------	---------